

Skill Level: BEGINNER These how-to's are suitable for people who are new to DIY and who have a basic knowledge of tools. If you've painted a room or re-potted a plant, you can probably complete one of these projects by yourself in a few hours or less.

✓ MATERIALS

- Cabinet Organizer Kit(s)
- Tape Measure
- Level
- Pencil
- Screwdrivers (Slotted/Standard and/or Cross-head/Phillips)
- Cordless Screwdriver or Drill and Bits—optional

If you ever find yourself digging through your kitchen cabinets and drawers, not being able to find what you're looking for, you could use cabinet organizers. They can decrease the clutter to get your kitchen back in order. Here are some practical tips for planning and installing two popular organizers that can make your kitchen more efficient.

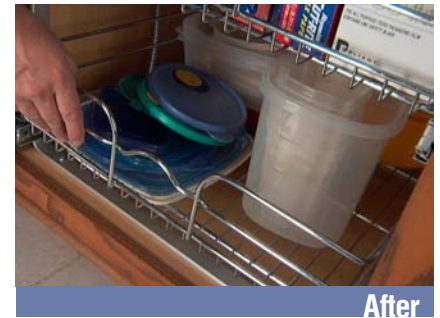

PLANNING

There are many types of kitchen organizers available including cabinet drawer and door units, lazy susans, sink and base organizers—and kits for your bathroom, closets and other household storage needs.

The best way to start is by making a plan.

For kitchens, professional designers recommend that you start by considering your kitchen's "work triangle", the relation of the sink to the refrigerator, refrigerator to the stove and stove to the sink.

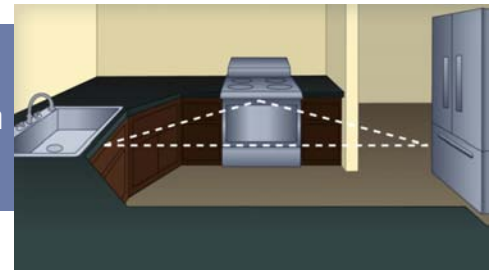

- **TIP:** Plan to make it as efficient as possible for each of the three primary jobs performed in your kitchen:

- Preparation

Make sure you have easy access to measuring cups, bowls, serving dishes and utensils.

- Cooking

Organize your pots, pans, cooking utensils and spice storage near the stove or microwave.

- Cleanup

Plan for easier cleanup near the sink with a handy trash container and food storage containers, plastic wrap and aluminum foil (for leftovers). An under-sink front tray organizer can store cleaning supplies, such as sponges and brushes.

IMPORTANT

Before you begin this project, read the manufacturer's instructions for all cabinet organizer kits you plan to install.

PLANNING (cont.)

Cabinet organizers are easy to install, even for beginning do-it-yourselfers. To plan for a successful installation:

01 Measure the interior depth, width and height of all cabinet openings in which you will install the organizers.

- **TIP:** If you are installing a roll-out organizer without a door mount, make sure you allow for the door swing in your measurements so the door or hinges don't interfere with the organizer's movement.

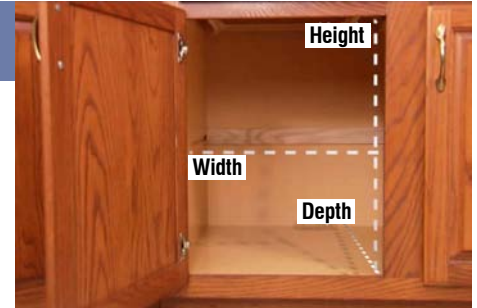

02 Purchase the cabinet organizer kits you plan to install. Ask a Lowe's associate for assistance if needed.

This step-by-step instruction sheet will guide you through two typical kitchen cabinet organizer installations, a pull-out trash can in a cabinet and a two-tiered wire basket near the stove for storing pots and pans.

- **TIP:** To make the job easier, take time to carefully read the manufacturer's instructions and make sure you understand each step before starting. Some manufacturers also have a Help Line you can call or a website you can visit for additional assistance. You can ask a Lowe's associate for more information, too.



TRASH CAN INSTALLATION

01 Place the trash can frame in the cabinet opening and close the door to verify that the unit fits and slides easily before installation. There should be sufficient clearance so the trash can and frame easily slide out without obstruction.

- **TIP:** If there are numerous parts to your kit, carefully lay them out on the floor or counter in the recommended sequence of installation to make the job easier.

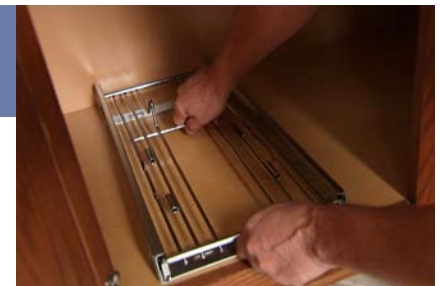

02 Line up the frame with the front of the cabinet.

03 Install the front screws on the inside of the cabinet as directed by the manufacturer's instructions.

- **TIP:** You may find it easier to drill pilot holes for the screws.

04 Open the frame, if necessary, and install the rear screws, and any other screws or hardware required to fasten the frame to the cabinet.

- If you have to remove the sliding frame to reach the rear screws, for most units you can extend the frame, pull the release tabs, then the unit will slide.



05 Place the trash can in the frame and slide the unit forward and back, making sure that it operates smoothly. Adjust the frame installation as needed.

TRASH CAN INSTALLATION (cont.)

For some trash can organizers you can purchase optional hardware to mount the door on the frame. Here's how to install it:

- 05 Remove the cabinet door by unscrewing the hinges.
- 06 Secure the L-brackets to the slides with the included hardware.
- 07 Loosely attach the door brackets to the L-brackets.
- 08 Verify that the door brackets will line up on a thick part of the door, so the screws won't protrude through the face. If they don't line up accordingly, install the included spacers.
- 09 Close the frame and apply double-sided tape to the brackets.
- 10 Refer to the adjacent drawer and/or cabinet door(s) to align the uninstalled door to the organizer frame. Apply pressure to the door to adhere it to the tape, then carefully pull the door and frame out from the bottom.
- 11 Insert screws through the door bracket holes and tighten the screws.
- 12 If the cabinet door looks crooked, loosen the mounting screws and make adjustments as needed.



WIRE BASKET INSTALLATION

This installation is for a two-tiered wire basket. Use the diagram to help identify parts of the system.

- 01 Remove the slides from the wire baskets by pulling up on the release trigger and pulling out the slides.
- 02 Measure the height required for the upper basket by holding your largest pot in place to determine how much room the basket will need. Most units will have several options for positioning the upper basket.

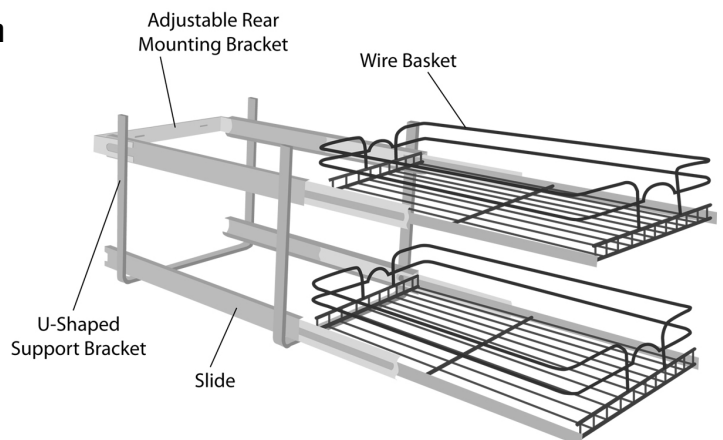

WIRE BASKET INSTALLATION (cont.)

- 03 Attach the top slides to the front U-shaped support bracket.
- 04 Loosely attach the slides to the rear U-shaped bracket. The adjustable rear-mounting bracket should be placed between the slide and the U-shaped support bracket.
- 05 Attach the lower slides to the U-shaped support brackets.
- 06 Set the frame inside the cabinet and slide it against the side opposite the hinges.
- 07 Position the frame so the front of the slide is 1/4" from the front of the cabinet.
- 08 Attach the SLIDE (not the bracket) to the cabinet with screws.
- 09 Verify that the holes in the bottom of the front U-shaped bracket is 1-13/16" back from the cabinet front.
- 10 Attach the brackets to the bottom of the cabinets with screws.
- 11 Extend the rear adjustable bracket to the back of the cabinet and secure it with screws.
- 12 Tighten the rear screws of upper slides to the U-shaped support brackets.
- 13 Install the baskets into the slides.



OTHER INSTALLATIONS

Your kitchen isn't the only place you can install handy organizers. There are similar systems for bathrooms, closets, bedrooms, garages and other areas. Ask a Lowe's associate for ideas on how to apply what you've learned about cabinet organizers to other storage problems in your home.

Now you can enjoy a much more efficient kitchen workspace. To see more ways you can improve your home, visit [Lowe's.com/Videos](https://www.lowes.com/Videos).

These "How-To's" are provided for informational purposes only. The information contained in Lowe's "How-To" videos is intended to provide general guidance to simplify jobs around the house. Because tools, products, materials, techniques, building codes and local regulations are continually changing, Lowe's assumes no responsibility for the accuracy of the information contained herein and disclaims any liability for omissions, errors or the outcome of any project. It is the responsibility of the viewer to ensure compliance with all applicable laws, rules, codes and regulations for a project. The viewer must always take proper safety precautions and exercise caution when taking on any project. If there is any question or doubt in regards to any element of a project, please consult with a licensed professional.